



**BUREAU
VERITAS**

TEST REPORT

LAB NO. : (8822)215-0088
DATE : Nov 8, 2022
PAGE : 1 OF 16

Applicant Name: ZHIWEI ROBOTICS CORP.
Applicant Address: ROOM 603, PU SOFT BUILDING, 2 BOYUN ROAD, PUDONG NEW AREA, SHANGHAI
Date of Submission: AUG 3, 2022
Test Period: AUG 3, 2022 TO NOV 8, 2022
Sample Description: BOSON SCIENCE KIT
Style No. : TOY0084 **Sample Size:** 2
Manufacturer: CHENGDU GEEKER TECHNOLOGY CO., LTD/成都极趣科技有限公司



BUREAU VERITAS SHENZHEN CO.,LTD
DONGGUAN BRANCH

Lisa Bai
Analytical lab Senior Supervisor

RT/Lucy Chen

REMARK

If there are questions or concerns on this report, please contact the following persons:

Report Enquiry: (86) 0769 89952999 Ext. 8175 CPSAnalytical.DG@bureauveritas.com

Business Contact: (86) 0769 85893595

This report shall not be reproduced except in full, without the written approval of our laboratory



LAB NO. : (8822)215-0088
DATE : Nov 8, 2022
PAGE : 2 OF 16

SUMMARY OF TEST RESULTS

TEST REQUESTED	CONCLUSION	REMARK
European Parliament and Council Directive 2011/65/EU on the Restriction of the Use of Certain Hazardous Substances in Electrical and Electronic Equipment (RoHS) with its Amendment Directive (EU)2015/863	PASS	-

Photo of Test Item(s)

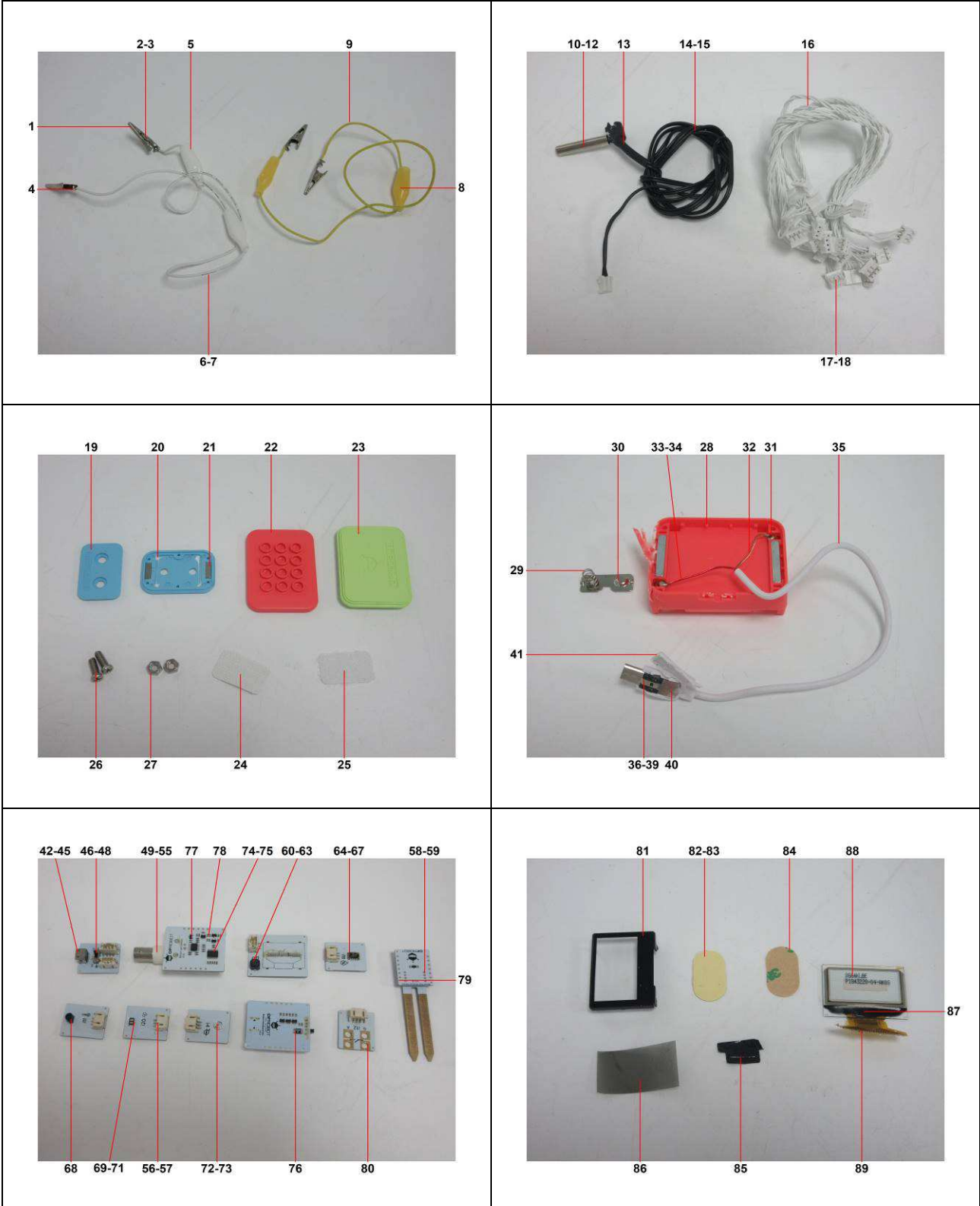
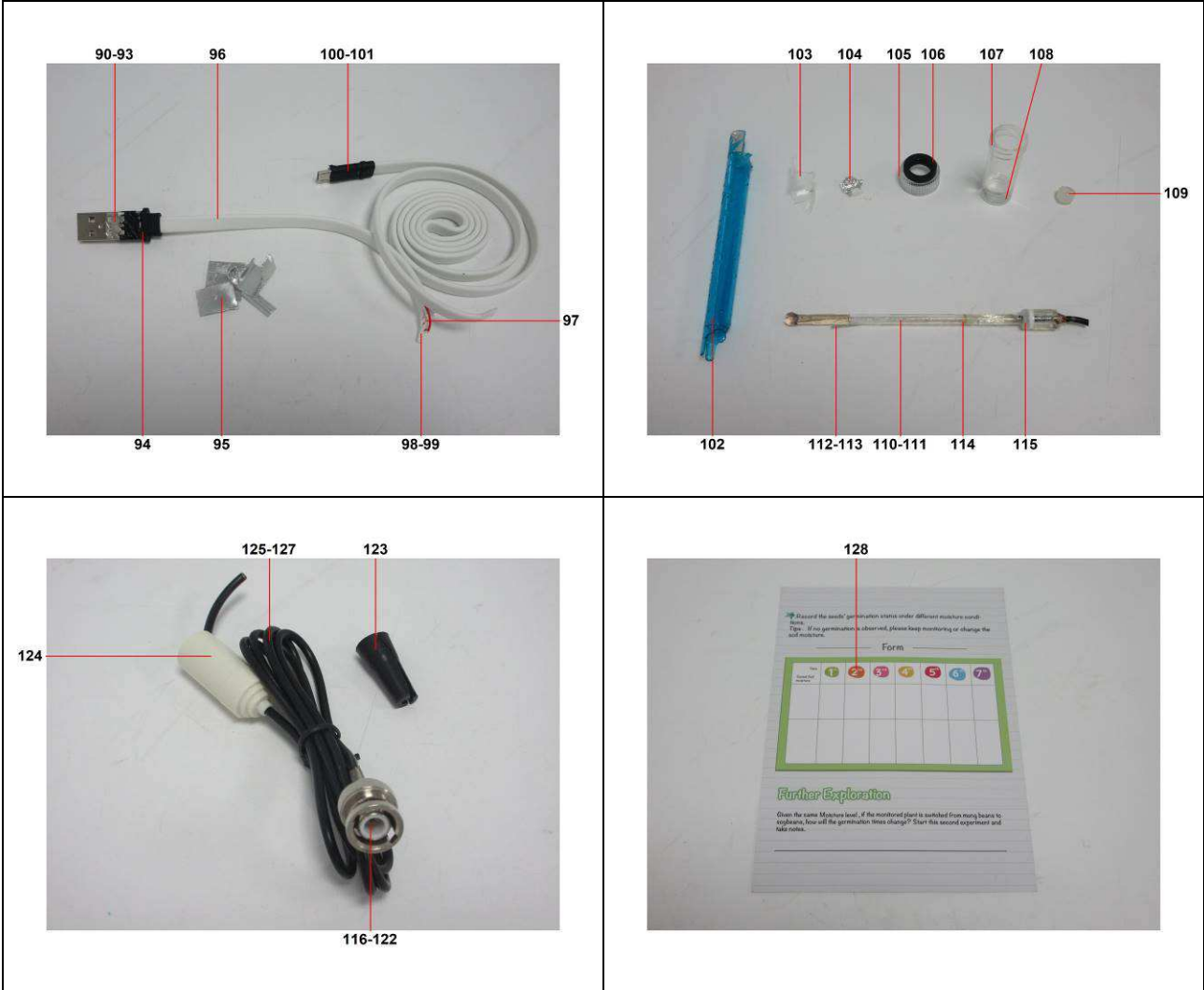

Photo of Test Item(s)





LAB NO. : (8822)215-0088
 DATE : Nov 8, 2022
 PAGE : 6 OF 16

Component Description List

Test Item(s)	Component Description(s)	Location	Style(s)
1	Silvery metal	Clip	-
2	Silvery metal	Shaft, clip	-
3	Silvery metal	Spring, clip	-
4	Silvery solder	Solder, clip	-
5	White soft plastic	Sleeve, clip	-
6	Black printed white soft plastic	Wire insulation, cable, clip	-
7	Silvery metal	Wire, cable, clip	-
8	Yellow soft plastic	Sleeve, clip	-
9	Black printed yellow soft plastic	Wire insulation, cable, clip	-
10	Silvery metal	Tube	-
11	Black plastic	Pipe, tube	-
12	Matte silvery metal	Pin, tube	-
13	Black soft plastic	Heat shrinkable tube, tube	-
14	Black soft plastic	Wire insulation, cable, tube	-
15	Coppery metal	Wire, cable, tube	-
16	White soft plastic	Wire insulation, cable, tube	-
17	White plastic	Socket, cable	-
18	Silvery metal	Pin, socket, cable	-
19	Blue plastic	Holder, PCB	-
20	White glue	Glue, holder, PCB	-
21	Silvery magnet	Magnet, holder, PCB	-
22	Red plastic	Holder, PCB	-
23	Cyan plastic	Holder, PCB	-
24	White plastic	Hook, Velcro	-
25	White plastic	Loop, Velcro	-
26	Silvery metal	Screw	-
27	Silvery metal	Nut	-
28	Red plastic	Battery holder	-
29	Silvery metal	Spring, battery holder	-
30	Silvery metal	Contact plate, battery holder	-
31	Silvery solder	Solder, battery holder	-
32	Coppery metal	Wire, cable, battery holder	-
33	Red metal	Wire, cable, battery holder	-
34	White fabric	Wire, cable, battery holder	-
35	White soft plastic	Wire insulation, cable, battery holder	-
36	Silvery metal	Contact plate, micro USB plug, cable, battery	-
37	Silvery metal	Pin, micro USB plug, cable, battery holder	-
38	Black plastic	Pin holder, micro USB plug, cable, battery holder	-

Component Description List

Test Item(s)	Component Description(s)	Location	Style(s)
39	Silvery solder	Solder, micro USB plug, cable, battery holder	-
40	Translucent plastic	Connector, micro USB plug, cable, battery holder	-
41	White soft plastic	Cover, micro USB plug, cable, battery holder	-
42	Silvery metal	Cover, micro USB plug, PCB	-
43	Silvery metal	Contact plate, micro USB plug, PCB	-
44	Silvery metal	Pin, micro USB plug, PCB	-
45	Black plastic	Pin holder, micro USB plug, PCB	-
46	Black plastic	Toggle switch, PCB	-
47	Brown plastic	Toggle switch, PCB	-
48	Silvery metal	Toggle switch, PCB	-
49	White plastic	Holder, plug, PCB	-
50	Silvery metal	Contact plate, plug, PCB	-
51	Golden metal	Pin, plug, PCB	-
52	White plastic	Pin holder, plug, PCB	-
53	White/translucent plastic	Pipe, plug, PCB	-
54	Silvery metal	Pin, plug, PCB	-
55	Matte silvery metal	Pin, plug, PCB	-
56	Beige plastic	Socket, PCB	-
57	Silvery metal	Pin, socket, PCB	-
58	Black plastic	Socket, PCB	-
59	Silvery metal	Pin, socket, PCB	-
60	Matte black plastic	Button, touch switch, PCB	-
61	Blue soft plastic	Button, touch switch, PCB	-
62	Silvery metal	Contact plate, touch switch, PCB	-
63	Black plastic	Base, touch switch, PCB	-
64	Black plastic	Cover, EC, PCB	-
65	Blue glue	Glue, EC, PCB	-
66	Silvery/black body	EC, PCB	-
67	Green plastic	Base, EC, PCB	-
68	Black body	Transistor, PCB	-
69	Transparent plastic with adhesive	Adhesive tape, SMD LED, PCB	-
70	Black soft plastic	Sleeve, SMD LED, PCB	-
71	Beige body	SMD LED, PCB	-
72	Transparent plastic	LED, PCB	-
73	Silvery metal	Pin, LED, PCB	-
74	Black body	IC, PCB	-
75	Silvery/coppery metal	Plate, IC, PCB	-
76	Black printed white body	SMD resistor, PCB	-
77	Black body	SMD transistor, PCB	-



LAB NO. : (8822)215-0088
 DATE : Nov 8, 2022
 PAGE : 8 OF 16

Component Description List

Test Item(s)	Component Description(s)	Location	Style(s)
78	Brown body	SMD capacitor, PCB	-
79	Silvery solder	Solder, PCB	-
80	Light blue/golden/brown PCB	PCB	-
81	Black plated silvery metal	Cover, display screen, PCB	-
82	Yellow paper	Holder, adhesive, display screen, PCB	-
83	Transparent adhesive	Adhesive, display screen, PCB	-
84	Green/brown paper	Holder, adhesive, display screen, PCB	-
85	Black plastic	Adhesive tape, display screen, PCB	-
86	Grey/translucent plastic	Film, display screen, PCB	-
87	Black glue	Glue, display screen, PCB	-
88	Silvery/transparent glass	Display screen, PCB	-
89	Brown FPC	FPC, display screen, PCB	-
90	Silvery metal	Contact plate, USB plug, cable, adapter	-
91	Silvery metal	Pin, USB plug, cable, adapter	-
92	White plastic	Pin holder, USB plug, cable, adapter	-
93	Silvery solder	Solder, USB plug, cable, adapter	-
94	Black soft plastic	Connector, USB plug, cable, adapter	-
95	Silvery metal	Cover, USB plug, cable, adapter	-
96	White soft plastic	Wire jacket, cable, adapter	-
97	Red soft plastic	Wire insulation, cable, adapter	-
98	White soft plastic	Wire insulation, cable, adapter	-
99	Coppery metal	Wire, cable, adapter	-
100	Silvery solder	Solder, micro USB plug, cable, adapter	-
101	Black soft plastic	Connector, micro USB plug, cable,	-
102	Blue/translucent plastic	Housing, tester	-
103	Transparent plastic	Sleeve, housing, tester	-
104	Silvery metal	Foil, housing, tester	-
105	Transparent plastic	Lid, tester	-
106	Black soft plastic	Lid, tester	-
107	Transparent plastic	Bottle, tester	-
108	Transparent liquid	Liquid, bottle, tester	-
109	Translucent soft plastic	Plug, tester	-
110	Transparent glass	Pipe, tester	-
111	Transparent liquid	Liquid, pipe, tester	-
112	Silvery metal	Wire, tester	-
113	Matte silvery metal	Terminal, wire, tester	-
114	Translucent soft plastic	Gasket, tester	-
115	White/translucent soft plastic	Gasket, tester	-
116	Silvery metal	Housing, plug, cable, tester	-
117	Silvery metal	Contact plate, plug, cable, tester	-



LAB NO. : (8822)215-0088
DATE : Nov 8, 2022
PAGE : 9 OF 16

Component Description List

Test Item(s)	Component Description(s)	Location	Style(s)
118	Golden metal	Pin, plug, cable, tester	-
119	White plastic	Pin holder, plug, cable, tester	-
120	Red soft plastic	Ring, plug, cable, tester	-
121	Silvery metal	Spring, plug, cable, tester	-
122	Silvery metal	Ring, plug, cable, tester	-
123	Black soft plastic	Hose, plug, cable, tester	-
124	Beige plastic	Cap, cable, tester	-
125	Black soft plastic	Wire jacket, cable, tester	-
126	Black soft plastic	Wire insulation, cable, tester	-
127	Coppery metal	Wire, cable, tester	-
128	Multi-color printed white paper	Film	-

TEST RESULT

Compliance Test – European Parliament and Council Directive 2011/65/EU on the Restriction of the Use of Certain Hazardous Substances in Electrical and Electronic Equipment (RoHS) with its Amendment Directive (EU)2015/863

Test Method : See Appendix.

-	Result (s)									
Parameter	Lead (Pb)	Mercury (Hg)	Cadmium (Cd)	Chromium VI (Cr VI)	PBBs & PBDEs	BBP	DBP	DEHP	DIBP	Conclusion
Unit	mg/kg									-
Test Item(s)	-	-	-	-	-	-	-	-	-	-
1	BL	BL	BL	BL	NA	NA	NA	NA	NA	PASS
2	BL	BL	BL	BL	NA	NA	NA	NA	NA	PASS
3	BL	BL	BL	BL	NA	NA	NA	NA	NA	PASS
4	BL	BL	BL	BL	NA	NA	NA	NA	NA	PASS
5	BL	BL	BL	BL	BL	BL*	610*	BL*	BL*	PASS
6	BL	BL	BL	BL	BL	BL*	BL*	BL*	BL*	PASS
7	BL	BL	BL	BL	NA	NA	NA	NA	NA	PASS
8	BL	BL	BL	BL	BL	BL*	BL*	BL*	BL*	PASS
9	BL	BL	BL	BL	BL	BL*	BL*	BL*	BL*	PASS
10	BL	BL	BL	BL	NA	NA	NA	NA	NA	PASS
11	BL	BL	BL	BL	BL	BL*	BL*	BL*	BL*	PASS
12	BL	BL	BL	BL	NA	NA	NA	NA	NA	PASS
13	BL	BL	BL	BL	BL	BL*	BL*	BL*	BL*	PASS
14	BL	BL	BL	BL	BL	BL*	BL*	100*	BL*	PASS
15	BL	BL	BL	BL	NA	NA	NA	NA	NA	PASS
16	BL	BL	BL	BL	BL	BL*	130*	BL*	BL*	PASS
17	BL	BL	BL	BL	BL	BL*	BL*	BL*	BL*	PASS
18	BL	BL	BL	BL	NA	NA	NA	NA	NA	PASS
19	BL	BL	BL	BL	BL	BL*	BL*	BL*	BL*	PASS
20	BL	BL	BL	BL	BL	BL*	BL*	BL*	BL*	PASS
21	BL	BL	BL	BL	NA	NA	NA	NA	NA	PASS
22	BL	BL	BL	BL	BL	BL*	BL*	BL*	BL*	PASS
23	BL	BL	BL	BL	BL	BL*	BL*	BL*	BL*	PASS
24	BL	BL	BL	BL	BL	BL*	BL*	BL*	BL*	PASS
25	BL	BL	BL	BL	BL	BL*	BL*	BL*	BL*	PASS
26	BL	BL	BL	Negative*	NA	NA	NA	NA	NA	PASS
27	BL	BL	BL	Negative*	NA	NA	NA	NA	NA	PASS
28	BL	BL	BL	BL	BL	BL*	BL*	BL*	BL*	PASS



LAB NO.
DATE
PAGE

: (8822)215-0088
: Nov 8, 2022
: 11 OF 16

TEST RESULT

-	Result (s)									
Parameter	Lead (Pb)	Mercury (Hg)	Cadmium (Cd)	Chromium VI (Cr VI)	PBBs & PBDEs	BBP	DBP	DEHP	DIBP	Conclusion
Unit	mg/kg									-
Test Item(s)	-	-	-	-	-	-	-	-	-	-
29	BL	BL	BL	Negative*	NA	NA	NA	NA	NA	PASS
30	BL	BL	BL	BL	NA	NA	NA	NA	NA	PASS
31	BL	BL	BL	BL	NA	NA	NA	NA	NA	PASS
32	BL	BL	BL	BL	NA	NA	NA	NA	NA	PASS
33	BL	BL	BL	BL	NA	NA	NA	NA	NA	PASS
34	BL	BL	BL	BL	BL	NA	NA	NA	NA	PASS
35	BL	BL	BL	BL	BL	BL*	BL*	BL*	BL*	PASS
36	BL	BL	BL	Negative*	NA	NA	NA	NA	NA	PASS
37	BL	BL	BL	BL	NA	NA	NA	NA	NA	PASS
38	BL	BL	BL	BL	BL	BL*	BL*	BL*	BL*	PASS
39	BL	BL	BL	BL	NA	NA	NA	NA	NA	PASS
40	BL	BL	BL	BL	BL	BL*	BL*	BL*	BL*	PASS
41	BL	BL	BL	BL	BL	BL*	BL*	BL*	BL*	PASS
42	BL	BL	BL	Negative*	NA	NA	NA	NA	NA	PASS
43	BL	BL	BL	Negative*	NA	NA	NA	NA	NA	PASS
44	BL	BL	BL	BL	NA	NA	NA	NA	NA	PASS
45	BL	BL	BL	BL	BL	BL*	BL*	BL*	BL*	PASS
46	BL	BL	BL	BL	BL	BL*	BL*	BL*	BL*	PASS
47	BL	BL	BL	BL	BL	BL*	BL*	BL*	BL*	PASS
48	BL	BL	BL	BL	NA	NA	NA	NA	NA	PASS
49	BL	BL	BL	BL	BL	BL*	BL*	BL*	BL*	PASS
50	BL	BL	BL	BL	NA	NA	NA	NA	NA	PASS
51	BL	BL	BL	BL	NA	NA	NA	NA	NA	PASS
52	BL	BL	BL	BL	BL	BL*	BL*	BL*	BL*	PASS
53	BL	BL	BL	BL	BL	BL*	BL*	BL*	BL*	PASS
54	BL	BL	BL	BL	NA	NA	NA	NA	NA	PASS
55	BL	BL	BL	BL	NA	NA	NA	NA	NA	PASS
56	BL	BL	BL	BL	BL	BL*	BL*	BL*	BL*	PASS
57	BL	BL	BL	BL	NA	NA	NA	NA	NA	PASS
58	BL	BL	BL	BL	BL*	BL*	BL*	BL*	BL*	PASS
59	BL	BL	BL	BL	NA	NA	NA	NA	NA	PASS
60	BL	BL	BL	BL	BL	BL*	BL*	BL*	BL*	PASS
61	BL	BL	BL	BL	BL	BL*	BL*	BL*	BL*	PASS



LAB NO. : (8822)215-0088
 DATE : Nov 8, 2022
 PAGE : 12 OF 16

TEST RESULT

-	Result (s)									
Parameter	Lead (Pb)	Mercury (Hg)	Cadmium (Cd)	Chromium VI (Cr VI)	PBBs & PBDEs	BBP	DBP	DEHP	DIBP	Conclusion
Unit	mg/kg									-
Test Item(s)	-	-	-	-	-	-	-	-	-	-
62	BL	BL	BL	Negative*	NA	NA	NA	NA	NA	PASS
63	BL	BL	BL	BL	BL	BL*	BL*	BL*	BL*	PASS
64	BL	BL	BL	BL	BL	BL*	BL*	BL*	BL*	PASS
65	BL	BL	BL	BL	BL	BL*	BL*	BL*	BL*	PASS
66	BL	BL	BL	BL	NA	NA	NA	NA	NA	PASS
67	BL	BL	BL	BL	BL*	BL*	BL*	BL*	BL*	PASS
68	BL	BL	BL	BL	NA	NA	NA	NA	NA	PASS
69	BL	BL	BL	BL	BL	BL*	BL*	70*	BL*	PASS
70	BL	BL	BL	BL	BL	BL*	BL*	BL*	BL*	PASS
71	BL	BL	BL	BL	NA	NA	NA	NA	NA	PASS
72	BL	BL	BL	BL	BL*	BL*	BL*	BL*	BL*	PASS
73	BL	BL	BL	BL	NA	NA	NA	NA	NA	PASS
74	BL	BL	BL	BL	NA	NA	NA	NA	NA	PASS
75	BL	BL	BL	BL	NA	NA	NA	NA	NA	PASS
76	BL	BL	BL	BL	NA	NA	NA	NA	NA	PASS
77	BL	BL	BL	BL	BL*	BL*	BL*	BL*	BL*	PASS
78	BL	BL	BL	BL	NA	NA	NA	NA	NA	PASS
79	BL	BL	BL	BL	NA	NA	NA	NA	NA	PASS
80	BL	BL	BL	BL	BL*	BL*	BL*	BL*	BL*	PASS
81	BL	BL	BL	BL	NA	NA	NA	NA	NA	PASS
82	BL	BL	BL	BL	BL	NA	NA	NA	NA	PASS
83	BL	BL	BL	BL	BL	BL*	BL*	BL*	BL*	PASS
84	BL	BL	BL	BL	BL	NA	NA	NA	NA	PASS
85	BL	BL	BL	BL	BL	BL*	BL*	BL*	BL*	PASS
86	BL	BL	BL	BL	BL	BL*	BL*	BL*	BL*	PASS
87	BL	BL	BL	BL	BL	BL*	BL*	170*	BL*	PASS
88	BL	BL	BL	BL	NA	NA	NA	NA	NA	PASS
89	BL	BL	BL	BL	BL	BL*	BL*	BL*	BL*	PASS
90	BL	BL	BL	BL	NA	NA	NA	NA	NA	PASS
91	BL	BL	BL	BL	NA	NA	NA	NA	NA	PASS
92	BL	BL	BL	BL	BL	BL*	BL*	BL*	BL*	PASS
93	BL	BL	BL	BL	NA	NA	NA	NA	NA	PASS
94	BL	BL	BL	BL	BL	BL*	BL*	BL*	BL*	PASS



LAB NO. : (8822)215-0088
 DATE : Nov 8, 2022
 PAGE : 13 OF 16

TEST RESULT

-	Result (s)									
Parameter	Lead (Pb)	Mercury (Hg)	Cadmium (Cd)	Chromium VI (Cr VI)	PBBs & PBDEs	BBP	DBP	DEHP	DIBP	Conclusion
Unit	mg/kg									-
Test Item(s)	-	-	-	-	-	-	-	-	-	-
95	BL	BL	BL	BL	NA	NA	NA	NA	NA	PASS
96	BL	BL	BL	BL	BL	BL*	BL*	BL*	BL*	PASS
97	BL	BL	BL	BL	BL	BL*	BL*	BL*	BL*	PASS
98	BL	BL	BL	BL	BL	BL*	BL*	BL*	BL*	PASS
99	BL	BL	BL	BL	NA	NA	NA	NA	NA	PASS
100	BL	BL	BL	BL	NA	NA	NA	NA	NA	PASS
101	BL	BL	BL	BL	BL	BL*	BL*	BL*	BL*	PASS
102	BL	BL	BL	BL	BL	BL*	BL*	BL*	BL*	PASS
103	BL	BL	BL	BL	BL	BL*	BL*	BL*	BL*	PASS
104	BL	BL	BL	BL	NA	NA	NA	NA	NA	PASS
105	BL	BL	BL	BL	BL	BL*	BL*	BL*	BL*	PASS
106	BL	BL	BL	BL	BL	BL*	BL*	80*	BL*	PASS
107	BL	BL	BL	BL	BL	BL*	BL*	BL*	BL*	PASS
108	BL	BL	BL	BL	BL	BL*	BL*	BL*	BL*	PASS
109	BL	BL	BL	BL	BL	BL*	BL*	BL*	BL*	PASS
110	109970*	BL	BL	BL	NA	NA	NA	NA	NA	EXEMPTED#
111	BL	BL	BL	BL	NA	NA	NA	NA	NA	PASS
112	BL	BL	BL	BL	NA	NA	NA	NA	NA	PASS
113	BL	BL	BL	BL	NA	NA	NA	NA	NA	PASS
114	BL	BL	BL	BL	BL	BL*	BL*	BL*	BL*	PASS
115	BL	BL	BL	BL	BL	BL*	BL*	BL*	BL*	PASS
116	26310*	BL	BL	BL	NA	NA	NA	NA	NA	EXEMPTED#
117	27840*	BL	BL	BL	NA	NA	NA	NA	NA	EXEMPTED#
118	24860*	BL	BL	BL	NA	NA	NA	NA	NA	EXEMPTED#
119	BL	BL	BL	BL	BL	BL*	BL*	BL*	BL*	PASS
120	BL	BL	BL	BL	BL	BL*	BL*	130*	BL*	PASS
121	BL	BL	BL	BL	NA	NA	NA	NA	NA	PASS
122	BL	BL	BL	BL	NA	NA	NA	NA	NA	PASS
123	BL	BL	BL	BL	BL	BL*	BL*	190*	BL*	PASS
124	BL	BL	BL	BL	BL	BL*	BL*	BL*	BL*	PASS
125	BL	BL	BL	BL	BL	BL*	170*	90*	BL*	PASS
126	BL	BL	BL	BL	BL	BL*	80*	160*	BL*	PASS



LAB NO. : (8822)215-0088
DATE : Nov 8, 2022
PAGE : 14 OF 16

TEST RESULT

-	Result (s)									
Parameter	Lead (Pb)	Mercury (Hg)	Cadmium (Cd)	Chromium VI (Cr VI)	PBBs & PBDEs	BBP	DBP	DEHP	DIBP	Conclusion
Unit	mg/kg									-
Test Item(s)	-	-	-	-	-	-	-	-	-	-
127	BL	BL	BL	BL	NA	NA	NA	NA	NA	PASS
128	BL	BL	BL	BL	BL	BL*	BL*	BL*	BL*	PASS

Note / Key:

BL = Below limit OL = Over limit ND = Not detected NA = Not applicable
mg/kg = milligram(s) per kilogram = ppm = part(s) per million
Detection Limit : See Appendix.

Remark:

- *Denotes as reported result(s) was (were) performed by wet chemistry method. Others were screened by XRF. For XRF screening, the result(s) of Cr VI was (were) reported as total chromium and the result(s) of PBBs and PBDEs was (were) reported as total bromine. Also, the XRF result(s) may be different to the actual content based on various factors including, but not limit to, sample size, thickness, area, non-uniformity composition, surface flatness.
- *Result(s) of Cr VI for metallic material(s) was (were) expressed in term of positive and negative. Negative means the absence of Cr VI on the tested areas and the result(s) was (were) regarded as in compliance with European Council Directive 2011/65/EU, Article 4(1). While, positive means the presence of Cr VI on tested areas and the result(s) was (were) regarded as in conflict with European Council Directive 2011/65/EU, Article 4(1).
- According to European Council Directive 2011/65/EU, Article 5 “Adaptation of the Annexes to scientific and technical progress”, exemption(s) should be granted to the materials and components of Test Item(s) in the lists in Annexes III and IV of this directive.
- #According to Annex III of European Council Directive 2011/65/EU, exemptions were granted a few materials and Clause 7(c)-I is reiterated here “Electrical and electronic components containing lead in a glass or ceramic other than dielectric ceramic in capacitors, e.g. piezo electronic devices, or in a glass or ceramic matrix compound”. Test Item(s) 110 was (were) claimed as is by client (received as is). Therefore, this (these) Test Item(s) containing the found lead level should be exempted.
- #According to Annex III of European Council Directive 2011/65/EU, exemptions were granted a few materials and Clause 6(c) is reiterated here “Copper alloy containing up to 4 % lead by weight”. Test Item(s) 116,117,118 was (were) claimed as is by client (received as is). Therefore, this (these) Test Item(s) containing the found lead level should be exempted.
- The items 31,39,123 were resubmitted by client dated on Oct 8, 2022.
- The items 4,8,12 were resubmitted by client dated on Oct 28, 2022

APPENDIX

List of Analytes and their Corresponding Test Methods, Detection Limit and Maximum Allowable Limit							
[Compliance Test for European Parliament and Council Directive 2011/65/EU] :							
No.	Name of Analytes	Detection Limit(mg/kg)				Wet Chemistry	Maximum Allowable Limit (mg/kg)
		X-ray fluorescence (XRF)^[a]					
		Plastic	Metal/Glass/ Ceramic	Others			
1	Lead (Pb)	100	200	200	10 ^[b]	1000	
2	Cadmium (Cd)	50	50	50	10 ^[b]	100	
3	Mercury (Hg)	100	200	200	10 ^[c]	1000	
4	Chromium (Cr)	100	200	200	NA	NA	
5	Chromium VI (Cr VI)	NA	NA	NA	See ^[d] /10 ^[e] /3 ^[f,g]	1000 / Negative ^[h]	
6	Bromine (Br)	200	NA	200	NA	NA	
7	Polybromobiphenyls (PBBs) - Bromobiphenyl (MonoBB) - Dibromobiphenyl (DiBB) - Tribromobiphenyl (TriBB) - Tetrabromobiphenyl (TetraBB) - Pentabromobiphenyl (PentaBB) - Hexabromobiphenyl (HexaBB) - Heptabromobiphenyl (HeptaBB) - Octabromobiphenyl (OctaBB) - Nonabromobiphenyl (NonaBB) - Decabromobiphenyl (DecaBB)	NA	NA	NA	Each 50 ^[i]	Sum 1000	
8	Polybromodiphenyl ethers (PBDEs) - Bromodiphenyl ether (MonoBDE) - Dibromodiphenyl ether (DiBDE) - Tribromodiphenyl ether (TriBDE) - Tetrabromodiphenyl ether (TetraBDE) - Pentabromodiphenyl ether (PentaBDE) - Hexabromodiphenyl ether (HexaBDE) - Heptabromodiphenyl ether (HeptaBDE) - Octabromodiphenyl ether (OctaBDE) - Nonabromodiphenyl ether (NonaBDE) - Decabromodiphenyl ether (DecaBDE)	NA	NA	NA	Each 50 ^[i]	Sum 1000	
9	- Dibutyl phthalate (DBP) - Butyl benzyl phthalate (BBP) - Di-2-ethylhexyl phthalate (DEHP) - Diisobutyl phthalate (DIBP)	NA	NA	NA	Each 50 ^[j]	Each 1000	



LAB NO. : (8822)215-0088
DATE : Nov 8, 2022
PAGE : 16 OF 16

NA = Not applicable IEC = International Electrotechnical Commission

- [a] Test method with reference to International Standard IEC 62321-3-1: 2013.
- [b] Test method with reference to International Standard IEC 62321-5: 2013.
- [c] Test method with reference to International Standard IEC 62321-4:2013+A1:2017.
- [d] Metal - Test method with reference to International Standard IEC 62321-7-1: 2015.
- [e] Polymers and Electronics - Test method with reference to European Standard EN 62321-7-2: 2017.
- [f] Leather - Test method International Standard ISO 17075-1:2017.
- [g] Other Than Metal, Leather, Polymers and Electronics - Test method with reference to International Standard ISO 17075-1:2017.
- [h] Result(s) of Cr VI for metallic material(s) was (were) expressed in term of positive and negative. Negative means the absence of Cr VI on the tested areas and the result(s) was (were) regarded as in compliance with European Parliament and Council Directive 2011/65/EU, Article 4(1). While, positive means the presence of Cr VI on tested areas and the result(s) was (were) regarded as in conflict with European Parliament and Council Directive 2011/65/EU, Article 4(1).
- [i] Test method with reference to International Standard IEC 62321-6: 2015.
- [j] Test method with reference to International Standard IEC 62321-8: 2017.

Testing Approach [Compliance Test for European Parliament and Council Directive 2011/65/EU] :

The testing approach was with reference to the following document(s).

- 1 International Standards IEC 62321-1: 2013 and IEC 62321-2: 2013
- 2 "RoHS Enforcement Guidance Document Version 1" by EU RoHS Enforcement Authorities Informal Network. (May 2006)
- 3 "RoHS Regulations - Government Guidance Notes" by United Kingdom Department for Business Innovation & Skills. (February 2011)
- 4 "Final Report to RoHS substances (Hg, Pb, Cr(VI), Cd, PBB and PBDE) in electrical and electronic equipment in Belgium" by Belgium Federal Public Service Health, Food Chain Safety and Environment. (November 2005)

*** End of Report ***